

PBR Application Guide

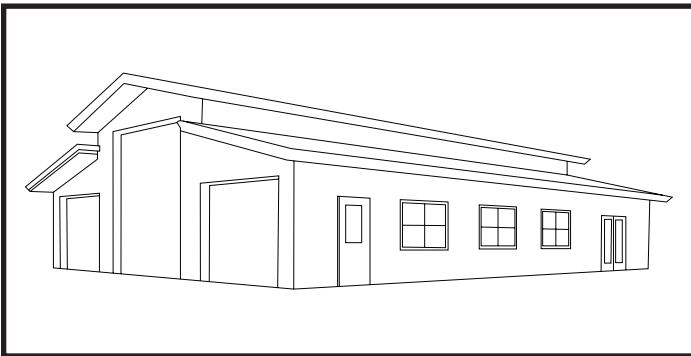
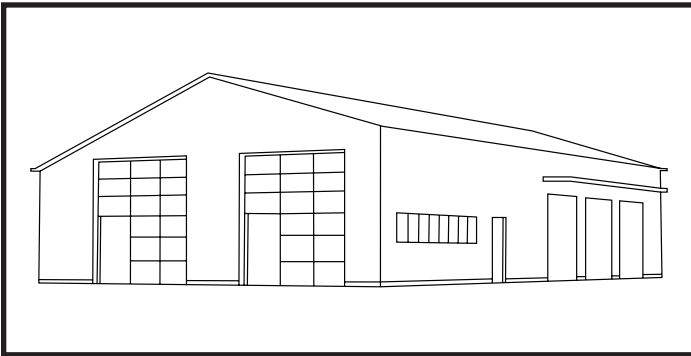
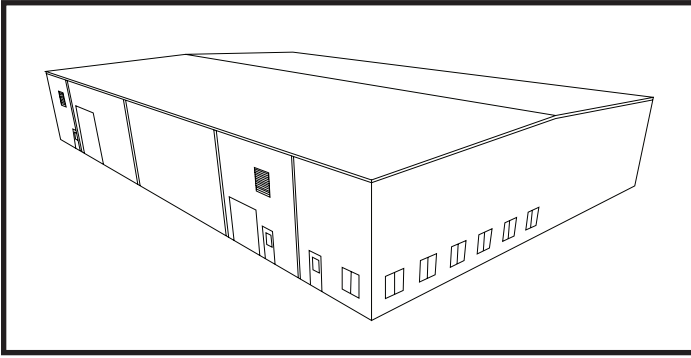

888.339.0059
www.everlastroofing.com

Table of Contents

PBR Trim	04
Application Guidelines	
Material Handling and Storage	05
Installation Recommendations	06
Coverage	07
PBR Details	
Wide Ridge Cap (PBR Panel)	08
Rake & Corner (PBR Panel)	08
Base Angle (PBR & "A" Panel)	09
Fascia Trim (PBR Panel)	09
"J" Channel (PBR & "A" Panel)	10
Double Angle (PBR & "A" Panel)	10
Universal Sidewall (PBR Panel)	11
Drip Cap (PBR & "A" Panel)	11
Universal Endwall (PBR Panel)	12
Inside Corner (PBR Panel)	12
Sculptured Rake (PBR Panel)	13
Sculptured Peak (PBR Panel)	13
Sil to Soffit (PBR & "A" Panel)	14
Outside (O/S) Corner ("A" Panel)	14
Inside (I/S) Corner ("A" Panel)	15

PBR Trim

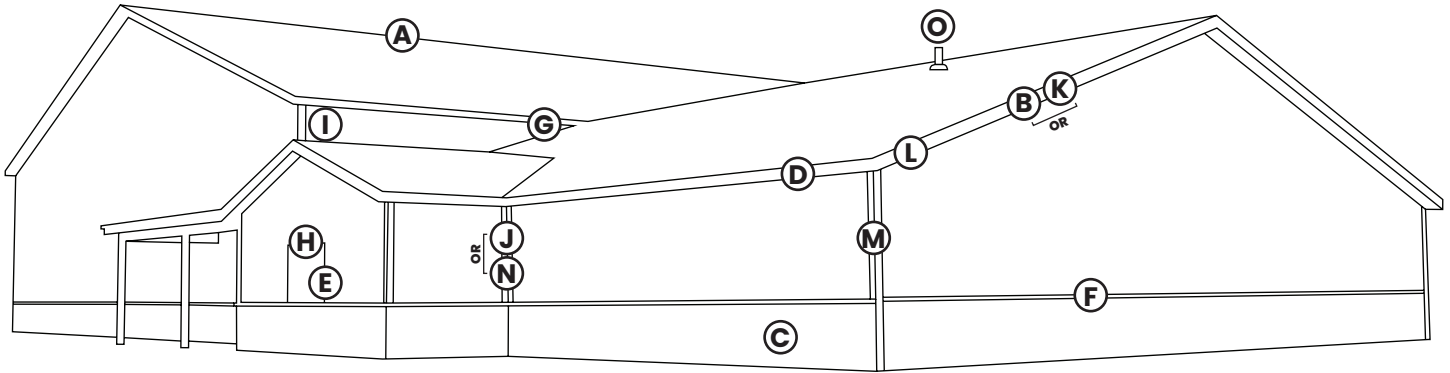

- | | | | |
|------------------|----------------------|---------------------|------------------------|
| Ⓐ Wide Ridge Cap | Ⓔ "J" Channel | Ⓛ Universal Endwall | Ⓜ Outside (O/S) Corner |
| Ⓑ Rake & Corner | ⓕ Double Angle | Ⓝ Inside Corner | Ⓝ Inside (I/S) Corner |
| Ⓒ Base Angle | ⓖ Universal Sidewall | Ⓚ Sculptured Rake | Ⓞ Pipe Flashing |
| Ⓓ Fascia Trim | ⓗ Drip Cap | Ⓛ Sil to Soffit | |

Purpose

This application guide is intended to assist in the application of commercial grade Everlast Roofing products on commercial structures. The details and illustrations in this manual may not be applicable to all building plans or field situations. It is the buyer's responsibility to verify all applicable code requirements, check all field measurements, and determine suitability of the material for the job.

Material Handling & Storage

Handling

- A. Handle all bundles and panels with care to prevent bending, distortion, or paint damage.
- B. Keep bundles crated until storage or installation. If opened, re-secure before lifting, and always lift at the center of gravity.
- C. Use a forklift for panels up to 20'-0", keeping forks at maximum spacing and never moving open bundles. Provide extra support over uneven terrain or long distances. Panels over 20'-0" should be lifted with a crane and spreader bar, keeping no more than one-third of the panel unsupported. Avoid cables or wire rope.
- D. Inspect panels before lifting. Panels over 5'-0" require at least two people, adding one for each additional 10'-0". Lift vertically—do not slide or drag panels, as this can damage the paint. Everlast Roofing, Inc. offers matching touch-up paint in a variety of standard colors in the event of any scratches to the paint finish.
- E. Carry panels on edge (vertical), not flat, with support every 6'-0" to 8'-0". Do not carry horizontally to prevent buckling.

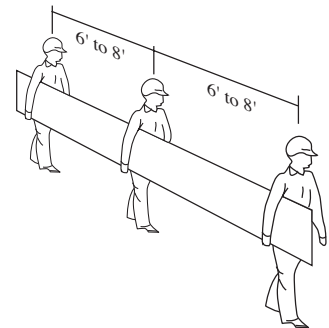
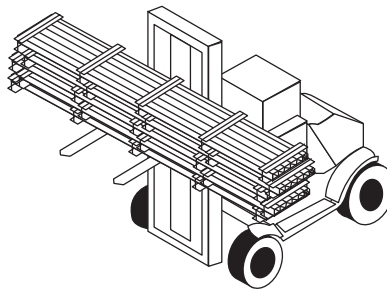
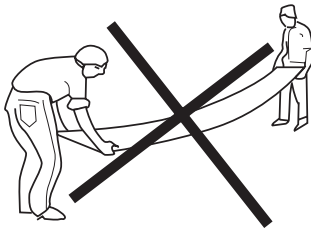

Storage

- A. If the material is not to be used immediately, it should be stored in a dry, well ventilated place. Any moisture should be removed immediately. Moisture trapped between sheets may cause damage to the paint system. The paint system may become soft or water stains may appear which can detract from the appearance and affect the service life of the material. Store bundles elevated off the ground and slightly sloped to prevent water accumulation and allow drainage. Cover with a loose, breathable tarp. **DO NOT USE PLASTIC TO COVER MATERIALS. THIS CAN CAUSE SWEATING OR CONDENSATION.**

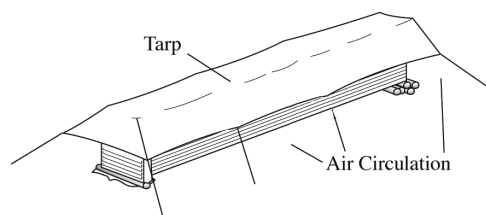

Installation Recommendations

Safety

Always work safely when installing metal products. Use extreme caution on a roof at all times, and wear gloves and safety glasses to avoid injury. Hearing protection should be used when power-cutting metal panels. Do not walk on panels until all fasteners are installed. Metal panels are slippery when wet, dusty, frosty, or oily. Do not attempt to walk on a metal roof under these conditions. Always use OSHA recommended safety harness or equipment when working on a roof. Wear soft-soled shoes to improve traction and to minimize damage to the paint finish. Always be aware of your position on the roof relative to any roof openings, roof edges, co-workers, and penetrations. Installing metal panels on a windy day can be dangerous and should be avoided. Consult OSHA guidelines for more comprehensive safety requirements.

Ventilation

Properly designing and installing vapor barriers and ventilation is essential to control condensation and avoid moisture-related damage or reduced insulation performance. Condensation forms when humid air contacts a surface at or below its dew point, a challenge common to all types of construction, not just metal buildings. For standard metal buildings without attics, installing faced insulation on the underside of the roof panels helps minimize condensation. In buildings with an attic or when retrofitting a metal roof, vents should be installed at both the eave and the peak to allow airflow and prevent excess moisture buildup in the attic space.

Cutting

Everlast recommends the use of tin snips or a “nibbler” type electric tool for field cutting metal panels. Cutting metal panels may create metal shavings.

- A. ***These shavings and/or chips must be removed immediately from the panel surface. Failure to remove such shavings or chips may cause staining and/or rust on the panel. Any such surface damage will void the warranty.***
- B. For your protection, goggles should be worn when cutting metal panels and flashing.

Touch Up Paint

Touch-up paint is used to cover and protect unexpected scratches on the paint finish that may occur during installation of the panel. Touch-up paint will not weather as well or at the same rate as the original coating or finish. When applying, use in small inconspicuous and separate areas. Test in an area that will not be noticeable.

PBR Coverage

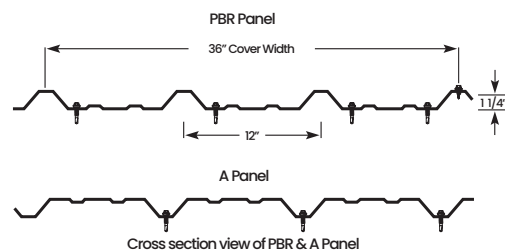
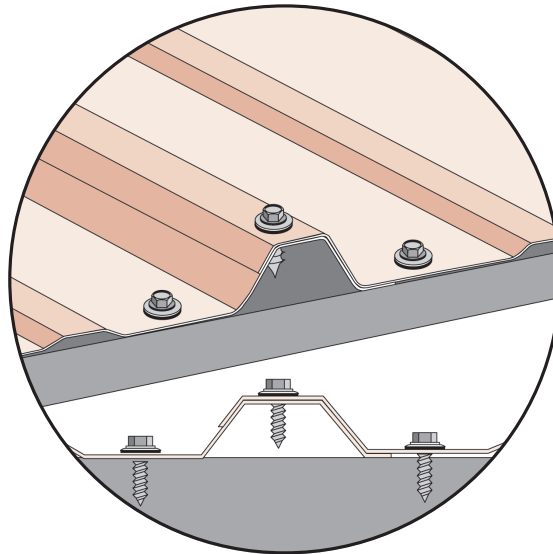
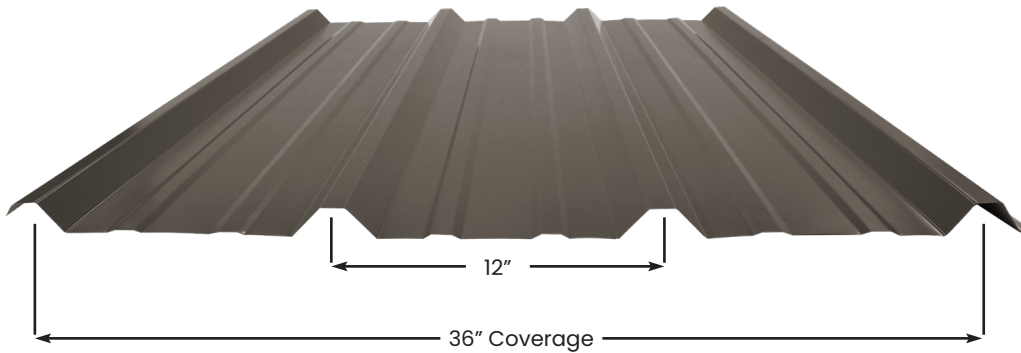

WIDE RIDGE CAP

26LAPBWRRCS122 - #933 20" Wide Ridge Cap for PBR

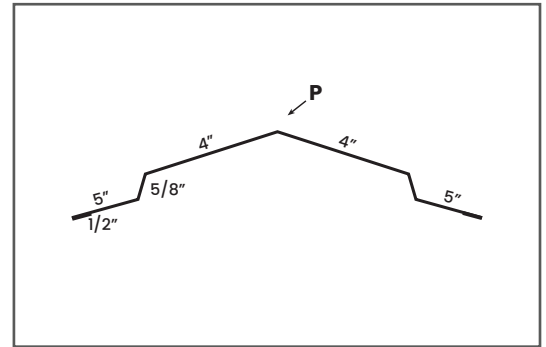
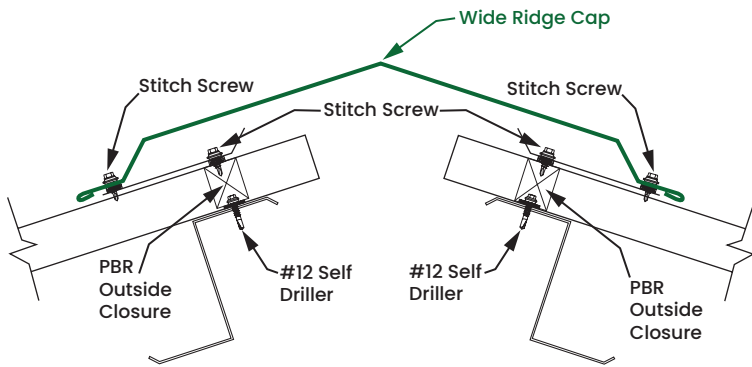

RAKE & CORNER

26LAPBRCS122 - #935 6" Rake & Corner for PBR

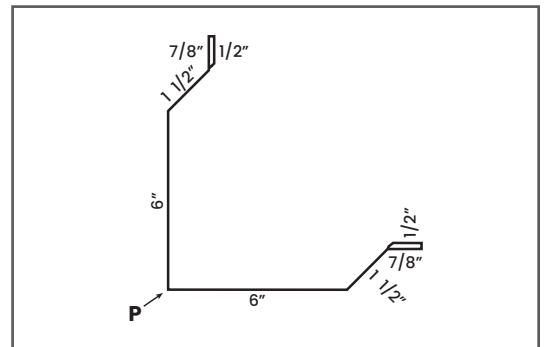
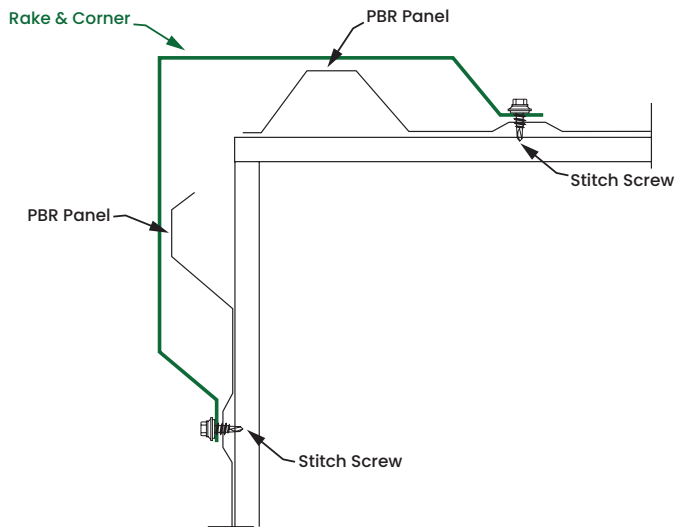

BASE ANGLE

26LAPBBAS122 - #941 Base Angle for PBR & "A"

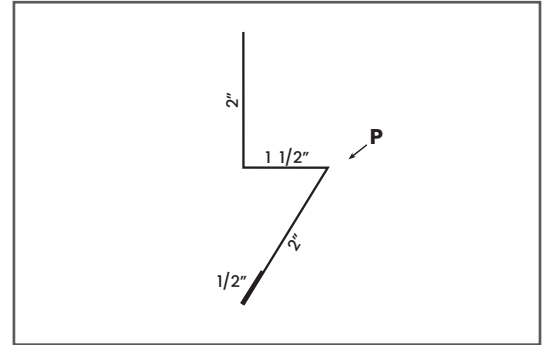
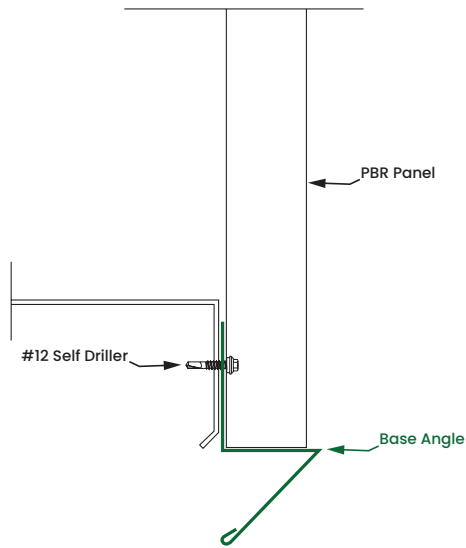

FASCIA TRIM

26LAPBFTS122 - #943 Fascia Trim for PBR

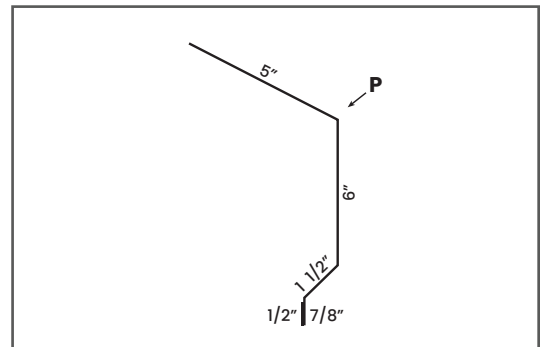
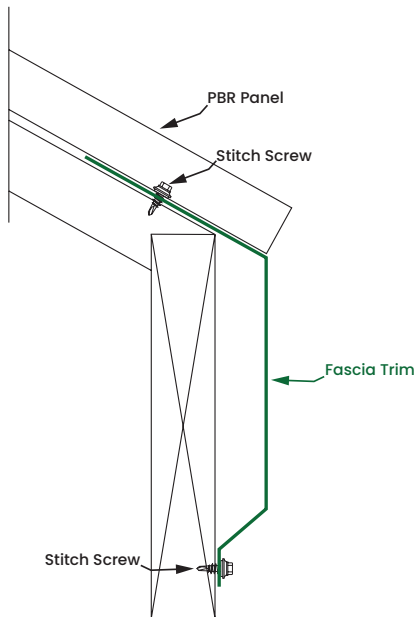

"J" CHANNEL

26LAPBJCS122 - #942 "J" Channel for PBR & "A"

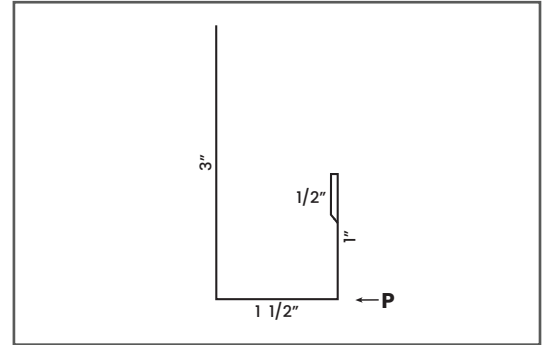
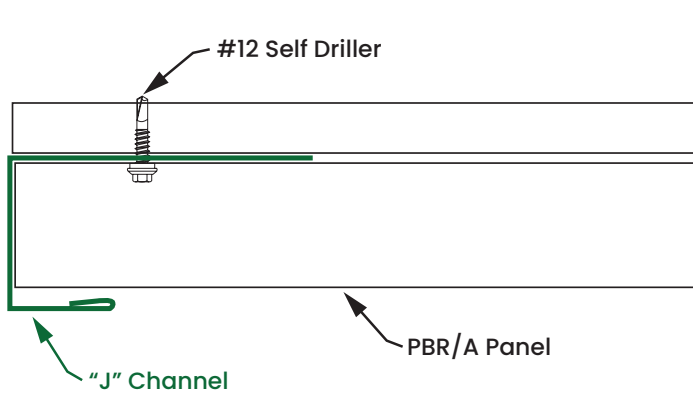

DOUBLE ANGLE

26LAPBDAS122 - #949 Double Angle for PBR & "A"

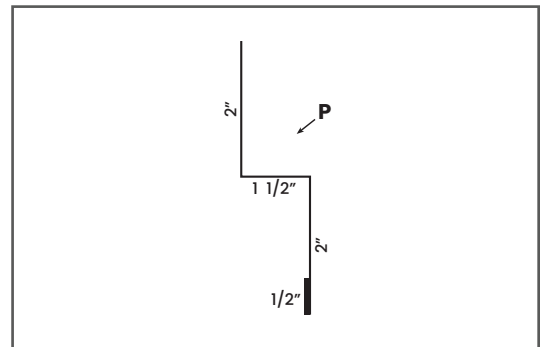
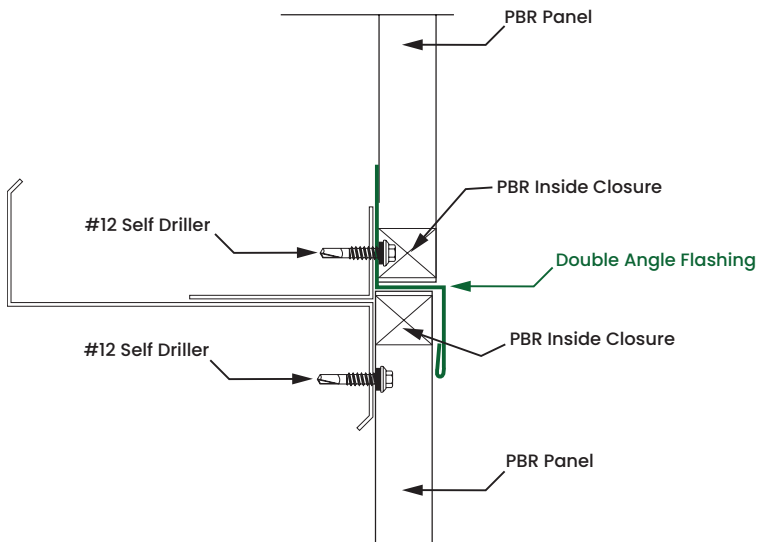

UNIVERSAL SIDEWALL

26LAPBUSS122 - #934 Universal Sidewall for PBR

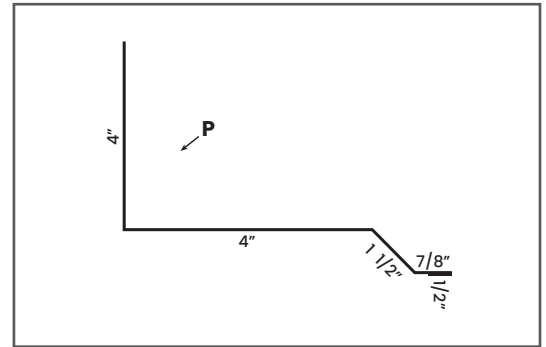
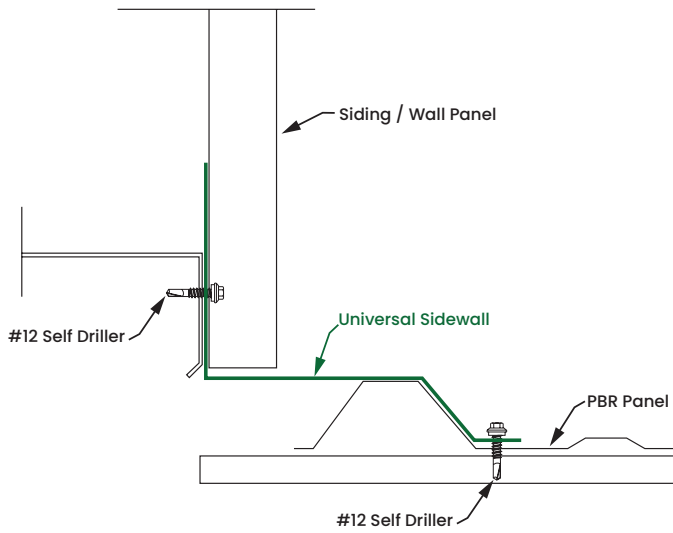

DRIP CAP

26LAPBDCS122 - #944 Drip Cap for PBR & "A"

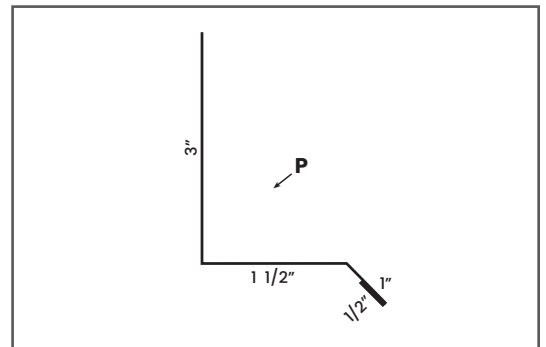
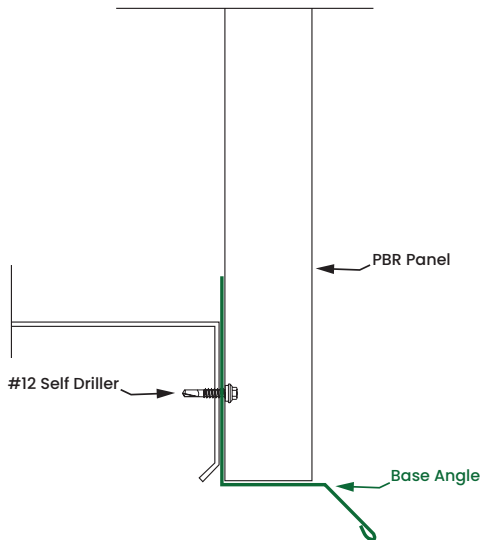

UNIVERSAL ENDWALL

26LAPBUES122 - #939 Universal Endwall for PBR

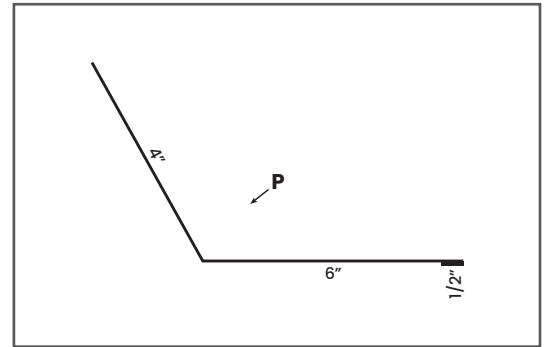
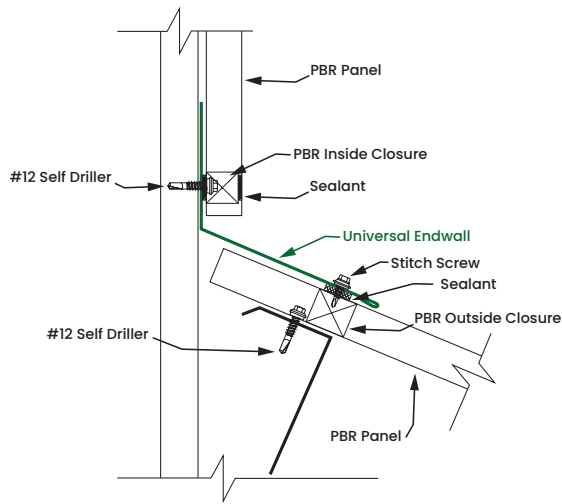

INSIDE CORNER

26LAPBICS122 - #948 Inside Corner for PBR

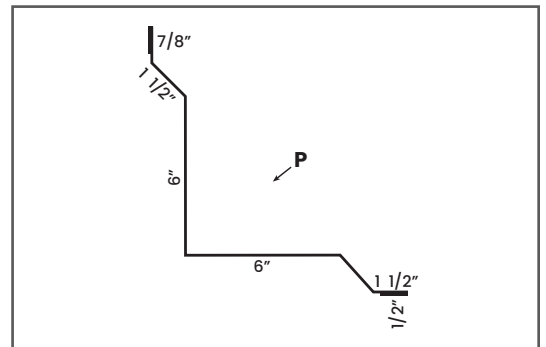
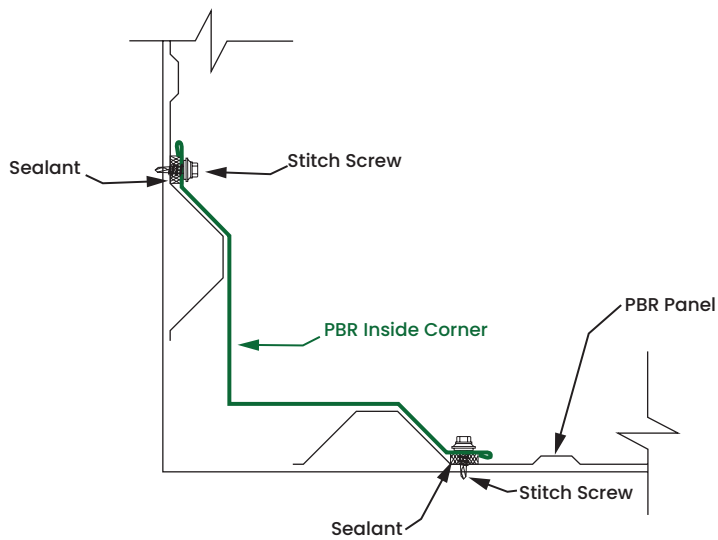

SCULPTURED RAKE

26LAPBRSI22 - #945 Sculptured Rake for PBR

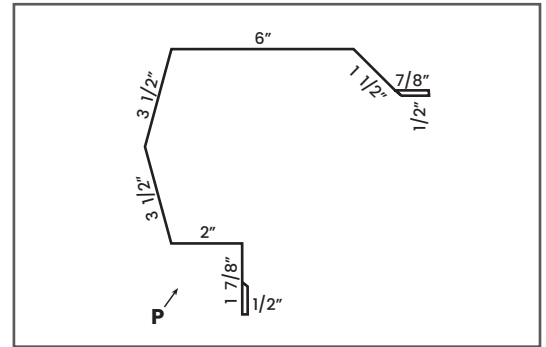
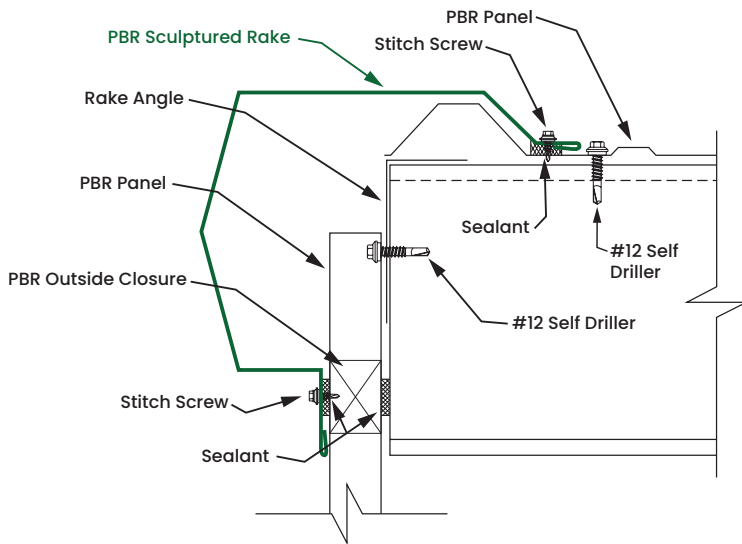

SCULPTURED PEAK

26LAPBSPS122 - #953 Sculptured Peak for PBR

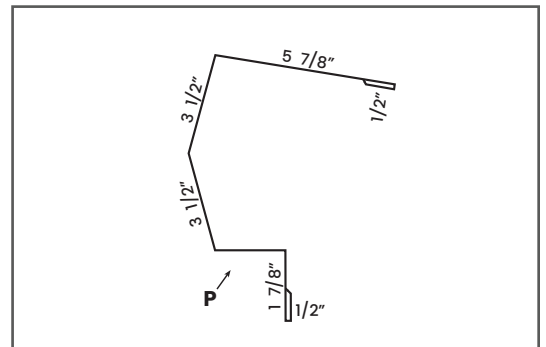
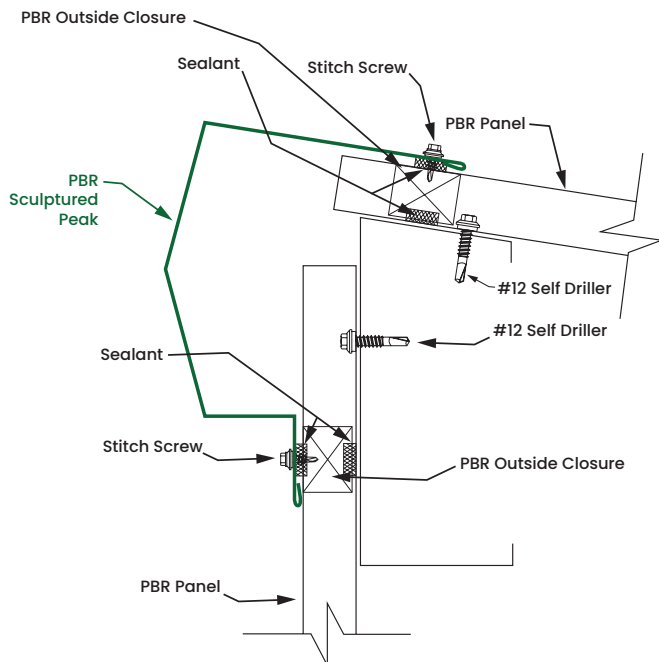

SIL TO SOFFIT

26LAPBSSS122 - #940 Sil to Soffit for PBR & "A"

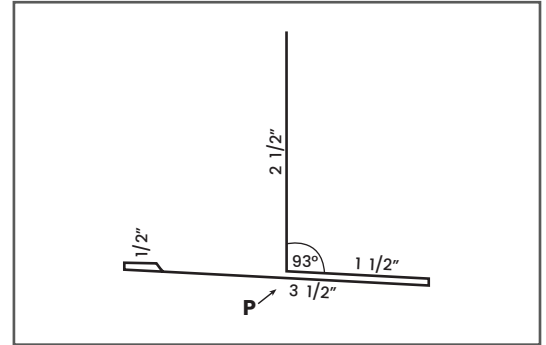
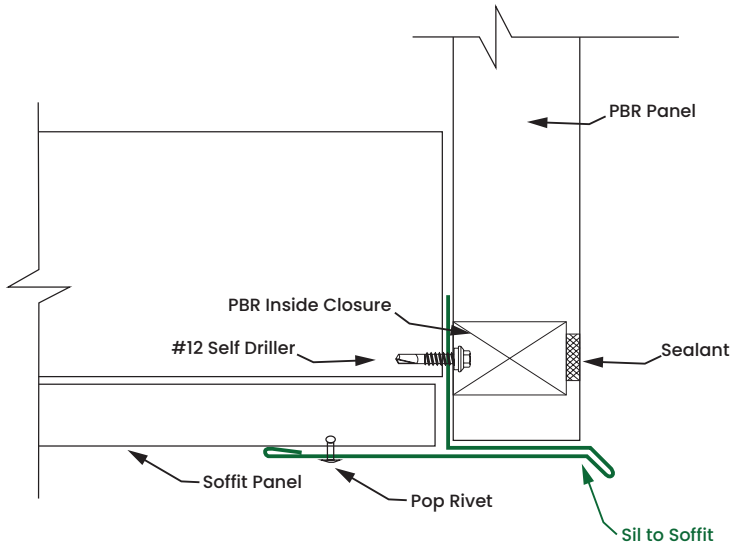

OUTSIDE (O/S) CORNER

26LAPBOCAS122 - #946 Outside (O/S) Corner for "A"

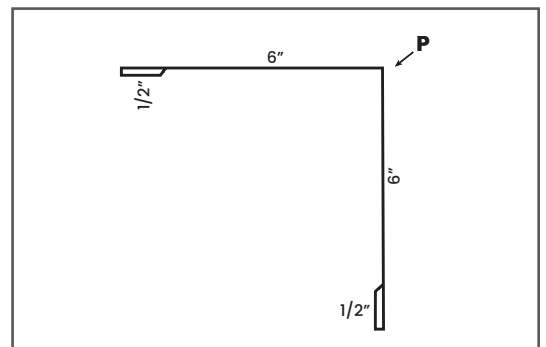
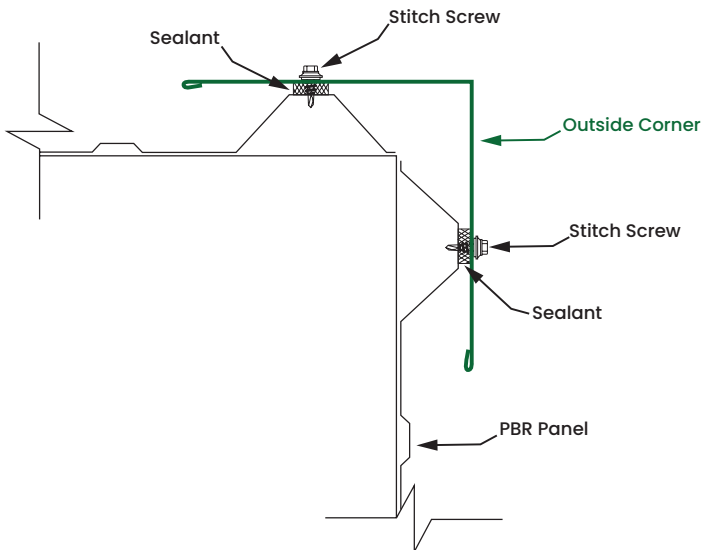

INSIDE (I/S) CORNER

26LAPBICAS122 - #947 Inside (I/S) Corner for "A"

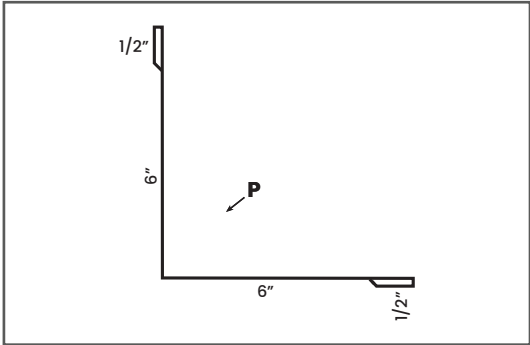
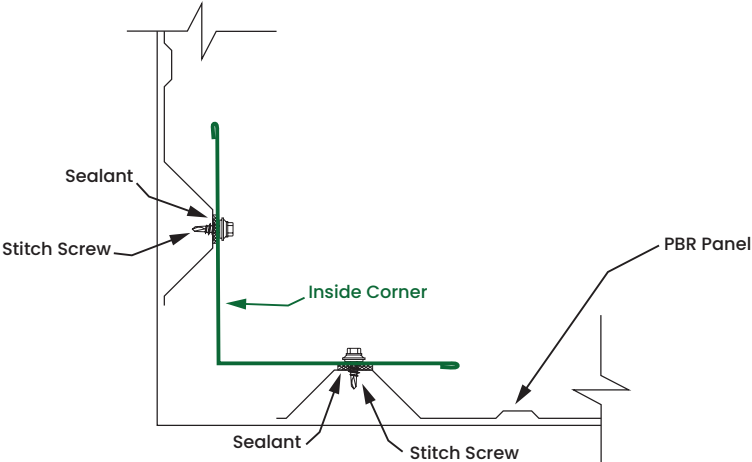





Everlast Roofing, Inc.

OUR NAME SAYS IT ALL

LEBANON, PA
888.339.0059

ORWELL, OH
877.866.9955

HOWE, IN
866.562.3782

BRIDGTON, ME
800.677.2060

EVERLASTROOFING.COM